

LEGEND

COUNTY LINE

CORPORATE LIMITS

STATE TRUNKLINE

COUNTY PRIMARY

COUNTY LOCAL

ADJACENT COUNTY

CITY OR VILLAGE

STREET

PRIMARY ROAD SYSTEM IS 15.54 MILES
 LOCAL ROAD SYSTEM IS 49.59 MILES

I HEREBY CERTIFY THAT THE ROADS SHOWN HEREON BY SYMBOL OR IN GREEN AS LOCAL ROADS ARE IN USE AND ARE UNDER THE JURISDICTION OF THE COUNTY ROAD COMMISSION.

CHAIRMAN _____ DATE _____

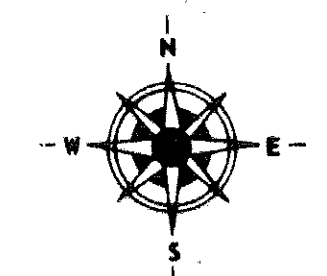

SCALE 0 1/2 1 MILE

 One inch equals 3000 feet

Livingston Co - 47 1.3N R.5

13

22|23
27|26

23|24
26|25

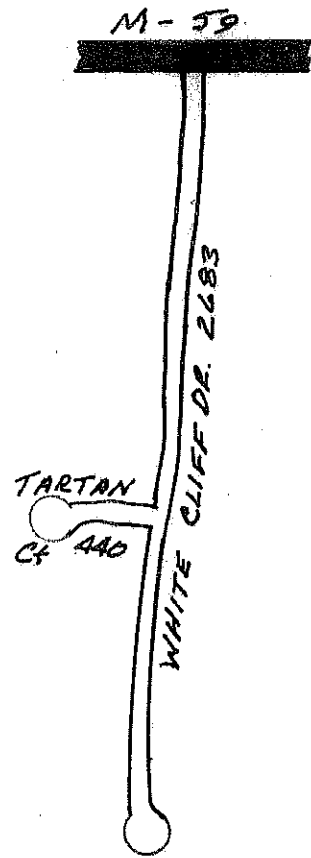

LEGEND

COUNTY LINE	— — — — —
CORPORATE LIMITS	— — — — —
STATE TRUNKLINE	—————
COUNTY PRIMARY	— — — — —
COUNTY LOCAL	— — — — —
ADJACENT COUNTY	
CITY OR VILLAGE STREET	—————

LOCAL ROAD SYSTEM
 TOTAL FEET 3123 EQUALS 0.59 MILES
 MILEAGES SHALL BE TO THE NEAREST ONE HUNDREDTH OF A MILE.

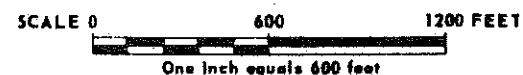
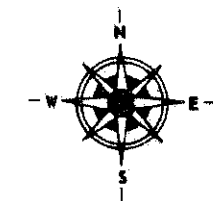

27|26
34|35

26|25
35|36

REVISED BY _____

DATE _____

TOWNSHIP OCOLA
 SECTION 26 T. 3N R. 5E
 COUNTY LIVINGSTON

13-A

20 | 21
29 | 28

21 | 22
28 | 27

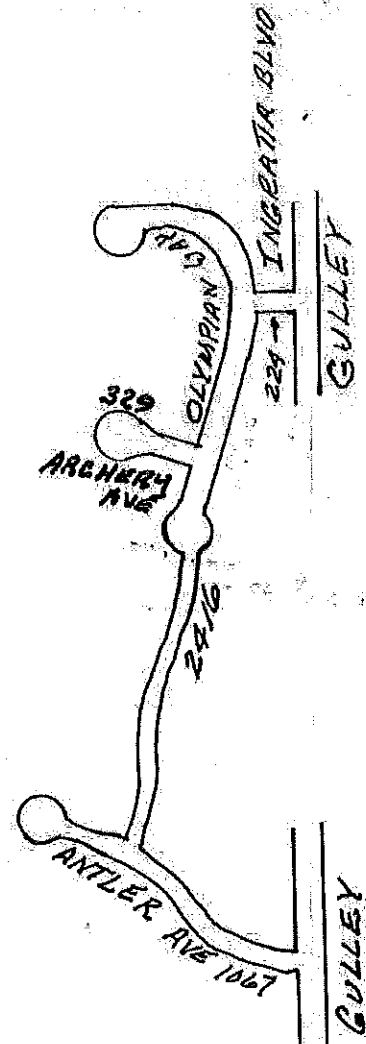

LEGEND

COUNTY LINE	-----
CORPORATE LIMITS	-----
STATE TRUNKLINE	-----
COUNTY PRIMARY	-----
COUNTY LOCAL	-----
ADJACENT COUNTY	-----
CITY OR VILLAGE	-----
STREET	-----

LOCAL ROAD SYSTEM
 TOTAL FEET 4036 EQUALS 0.76 MILES
 MILEAGES SHALL BE TO THE NEAREST ONE HUNDREDTH OF A MILE.

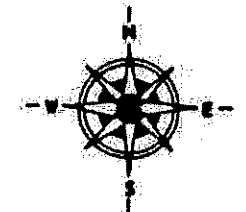

SCALE 0 600 1200 FEET
 One inch equals 600 feet

REVISED BY _____

DATE _____

TOWNSHIP OCOLA
 SECTION 28 T. 3N R. 5E
 COUNTY LIVINGSTON

29 | 28
32 | 33

28 | 27
33 | 34

13-B

LEGEND

COUNTY LINE	---
CORPORATE LIMITS	----
STATE TRUNKLINE	=====
COUNTY PRIMARY	=====
COUNTY LOCAL	=====
ADJACENT COUNTY	
CITY OR VILLAGE	
STREET	

TOTAL FEET 1,770 EQUALS 0.34 MILES

I HEREBY CERTIFY THAT THE ROADS SHOWN
HEREON BY SYMBOL OR IN GREEN AS LOCAL
ROADS ARE IN USE AND ARE UNDER THE JURIS-
DICTION OF THE COUNTY ROAD COMMISSION.

CHAIRMAN _____ DATE _____

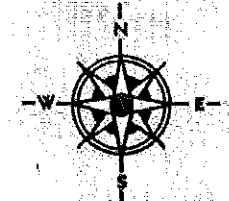
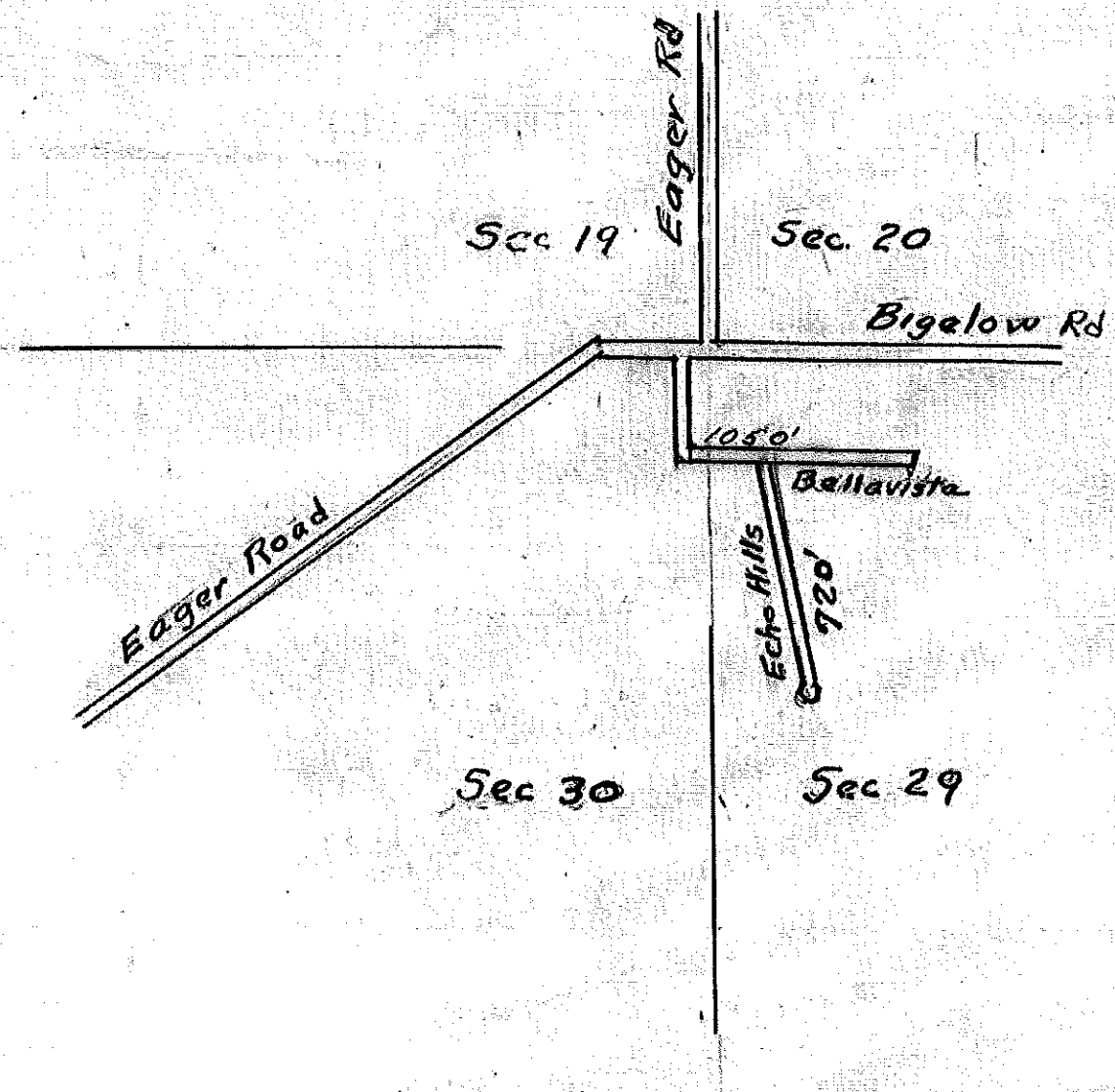

SCALE 0 600 1800 FEET
One inch equals 600 feet

TOWNSHIP OCEOLA
SECTION 29-30 T. 3N R. 5E
COUNTY LIVINGSTON

Prepared by
MICHIGAN STATE HIGHWAY DEPARTMENT

13-C

24 19
25 30

19 20
30 29

LEGEND

- COUNTY LINE
- CORPORATE LIMITS
- STATE TRUNKLINE
- COUNTY PRIMARY
- COUNTY LOCAL
- ADJACENT COUNTY
- CITY OR VILLAGE
- STREET

LOCAL ROAD SYSTEM

TOTAL FEET 7529 EQUALS 1.43 MILES

MILEAGES SHALL BE TO THE NEAREST ONE HUNDREDTH OF A MILE.

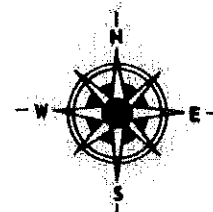

SCALE 0 600 1200 FEET

One Inch equals 600 feet

Howell
OCEOLA

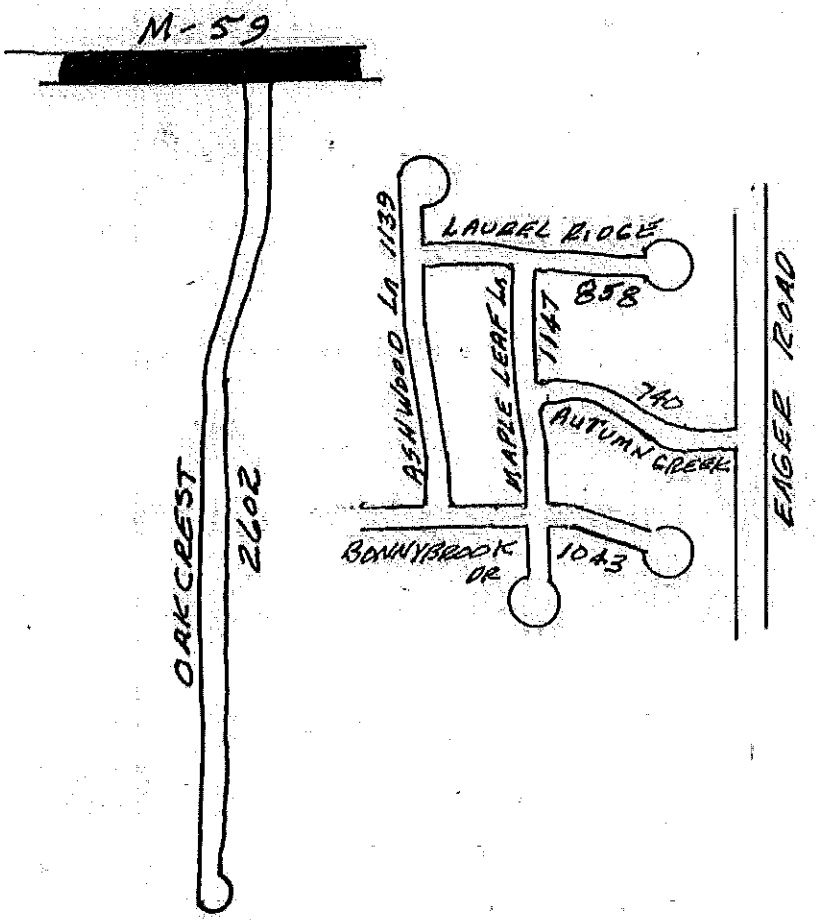

25 30
36 31

30 29
31 32

REVISED BY _____

DATE _____

TOWNSHIP OCEOLA

SECTION 30 T. 3 N. R. 5 E.

COUNTY LIVINGSTON

13-D

25 30
36 31

30 29
31 32

COUNTY LINE
 CORPORATE LIMITS
 STATE TRUNKLINE
 COUNTY PRIMARY
 COUNTY LOCAL
 ADJACENT COUNTY
 CITY OR VILLAGE
 STREET

TOTAL FEET 16,400 EQUALS 3.11 MILES

I HEREBY CERTIFY THAT THE ROADS SHOWN HEREON BY SYMBOL OR IN GREEN AS LOCAL ROADS ARE IN USE AND ARE UNDER THE JURISDICTION OF THE COUNTY ROAD COMMISSION.

CHAIRMAN _____ DATE _____

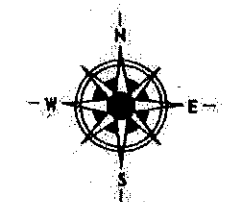

SCALE 0 600 1200 FEET
One Inch equals 600 feet

TOWNSHIP OCEOLA
SECTION 31-32 T. 3 N R. 5 E
COUNTY LIVINGSTON

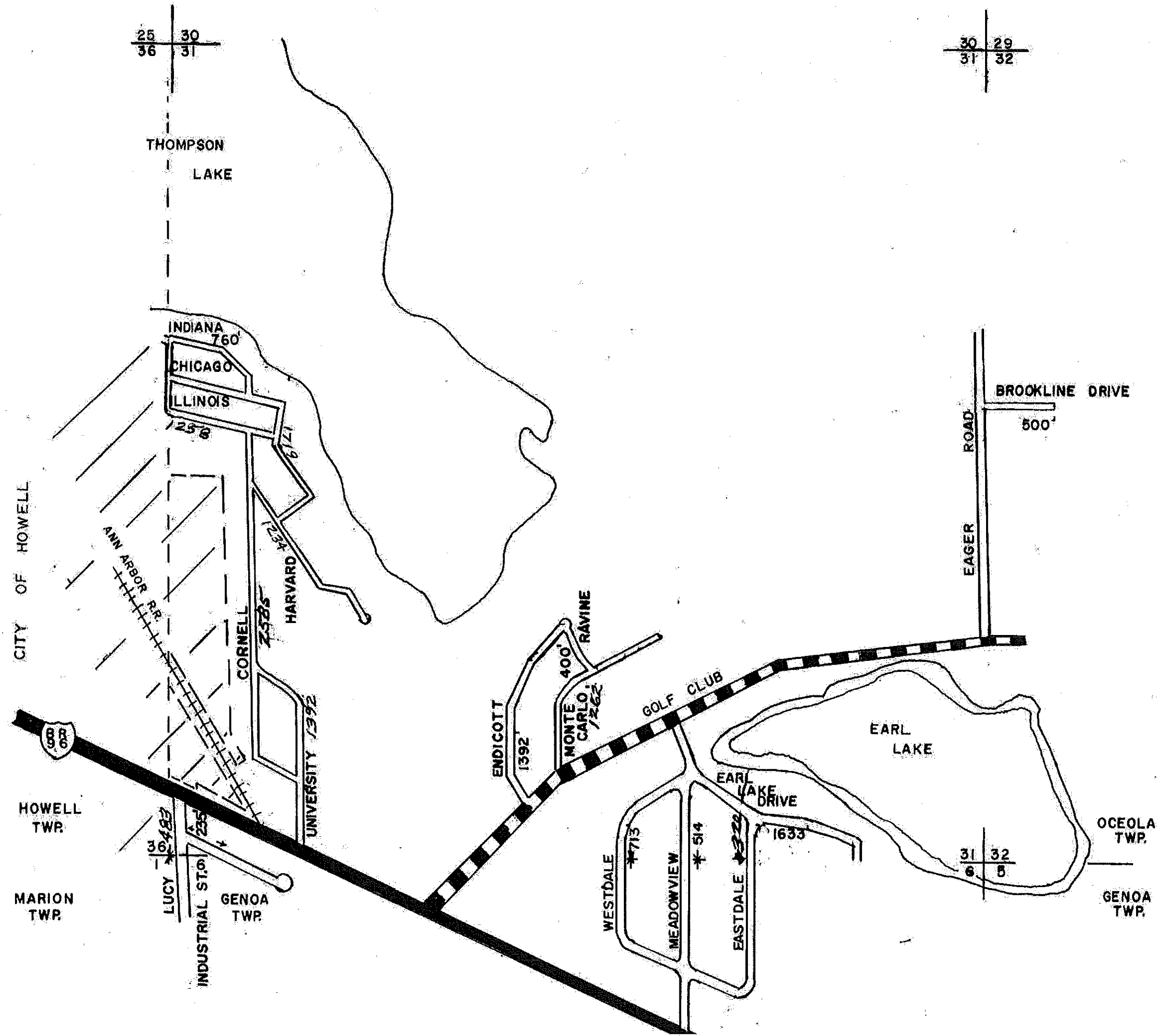

13-E

29 | 28
32 | 33

28 | 27
33 | 34

LEGEND

COUNTY LINE	_____
CORPORATE LIMITS	_____
STATE TRUNKLINE	=====
COUNTY PRIMARY	-----
COUNTY LOCAL	-----
ADJACENT COUNTY	
CITY OR VILLAGE	
STREET	_____

LOCAL ROAD SYSTEM

TOTAL FEET 3866 EQUALS 0.73 MILES

MILEAGES SHALL BE TO THE NEAREST ONE HUNDREDTH OF A MILE.

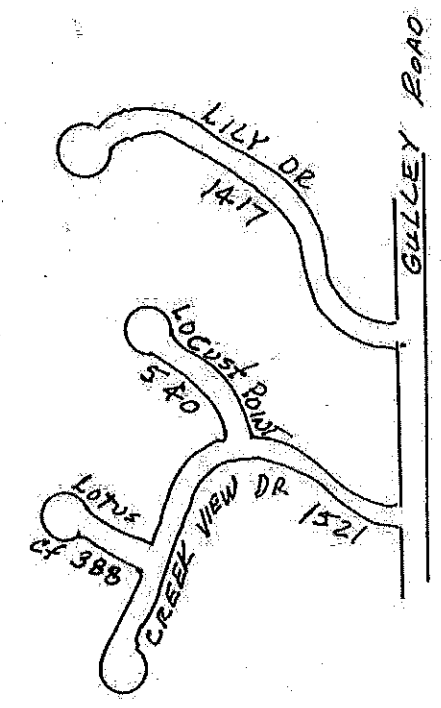

REVISED BY _____

DATE _____

TOWNSHIP Occola

SECTION 33 T. 3N R. 5E

COUNTY Livingston

13-F

32 | 33

33 | 34